

# PARSELASYON PLANI

İLİ : DENİZLİ  
İLÇESİ : PAMUKKALE  
MAHALLESİ : BAGBAŞI  
ADA NO : 119  
PARSEL NO : 3

4 177 900

4 177 800

424 600

4 177 700

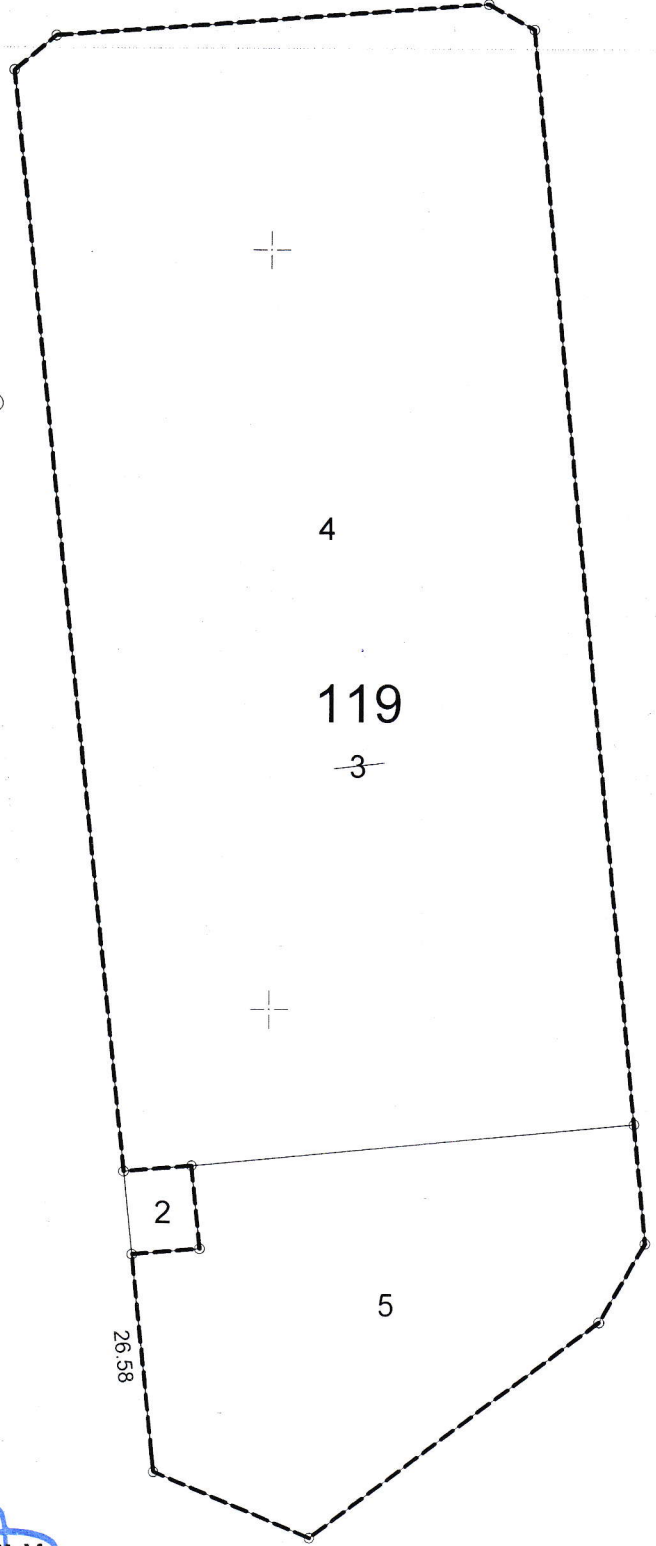

**Nazım TANRIKULU**  
Harita ve Kadastro Müh.  
Oda Sicil No: 1930  
Gsm: 0532 615 78 77

424 700